

HOLD HARMLESS COVENANT

This Hold Harmless Covenant is hereby executed this ____ day of _____, 2019, by MAINSTREET CV 76 S. LAURA ST., LLC., a Delaware Limited Liability Company, ("Grantee"); whose address is 2101 West Commercial Boulevard, Suite 1200, Fort Lauderdale, FL 33309, in favor of the CITY OF JACKSONVILLE, a Municipal Corporation, whose mailing address is 117 Duval Street West, Jacksonville, FL 32202.

IN CONSIDERATION for the Aerial Easement, by CITY ORDINANCE _____, a copy of which has been attached hereto and incorporated by reference.

MAINSTREET CV 76 S. LAURA ST., LLC., The Applicant and Grantee, its successors and assigns, holds harmless, indemnifies, and will defend the CITY OF JACKSONVILLE, its members, officials, officers, employees, and agents against any claim, action, loss, damage, injury liability, cost, and expense of whatever kind or nature (including, but not by way of limitation, attorney fees and court costs) arising out of injury (whether mental or corporeal) to persons, including death, or damage to property, arising out of or incidental to the use of the Aerial Easement Area, more particularly described in Exhibit "A," attached hereto including, but not limited to such injuries or damages resulting from flooding or erosion. This Hold Harmless Covenant shall run with the real property described in Exhibit "A."

Signed and Sealed in Our Presence:

GRANTOR:
MAINSTREET CV 76 S. LAURA ST
LLC.,

(Sign) _____
(Print) _____

By: _____

Its Managing Member

(Sign) _____
(Print) _____

STATE OF _____
COUNTY OF _____

The foregoing was acknowledged before me this ____ day of _____, 2019, by _____ as _____, MAINSTREET CV 76 S. LAURA ST., LLC., on behalf of the company. Such person is personally known to me or produced _____ as identification.

NOTARY PUBLIC
State of _____

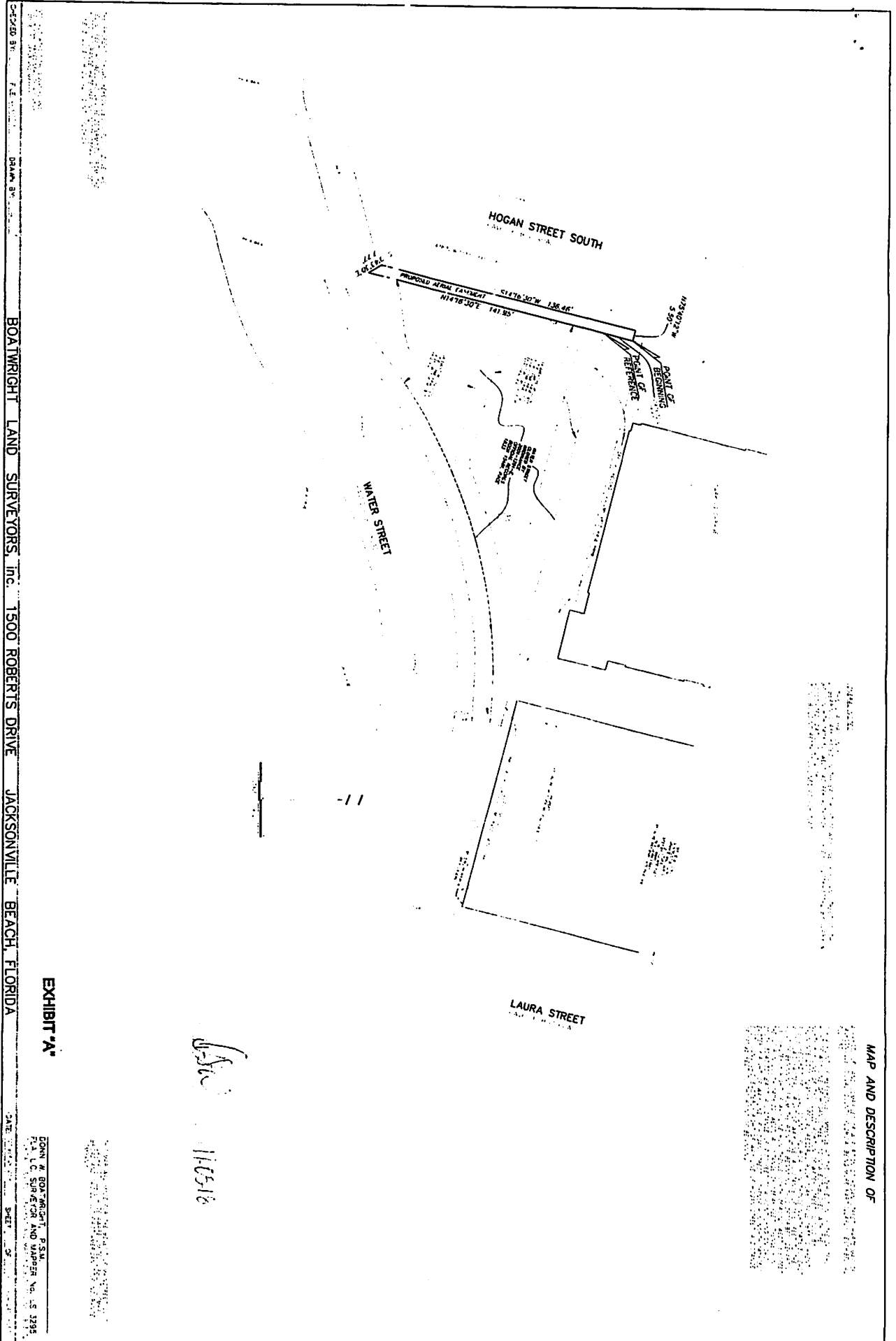

CHECKED BY: F.E. ... DRAWN BY: ... BOATWRIGHT LAND SURVEYORS, INC. 1500 ROBERTS DRIVE JACKSONVILLE BEACH, FLORIDA

EXHIBIT 'A'

DOAN & BOATWRIGHT, P.S.A.
 F.L.A. L.C. SURVEYOR AND MAPPER No. 5 1255

11-05-12

MAP AND DESCRIPTION OF

[Dotted area for map and description]